

## Service description

Product: VM420	Service description No: 4120-S001	Ver: 3
-------------------	---	-----------

### Specification valve settings

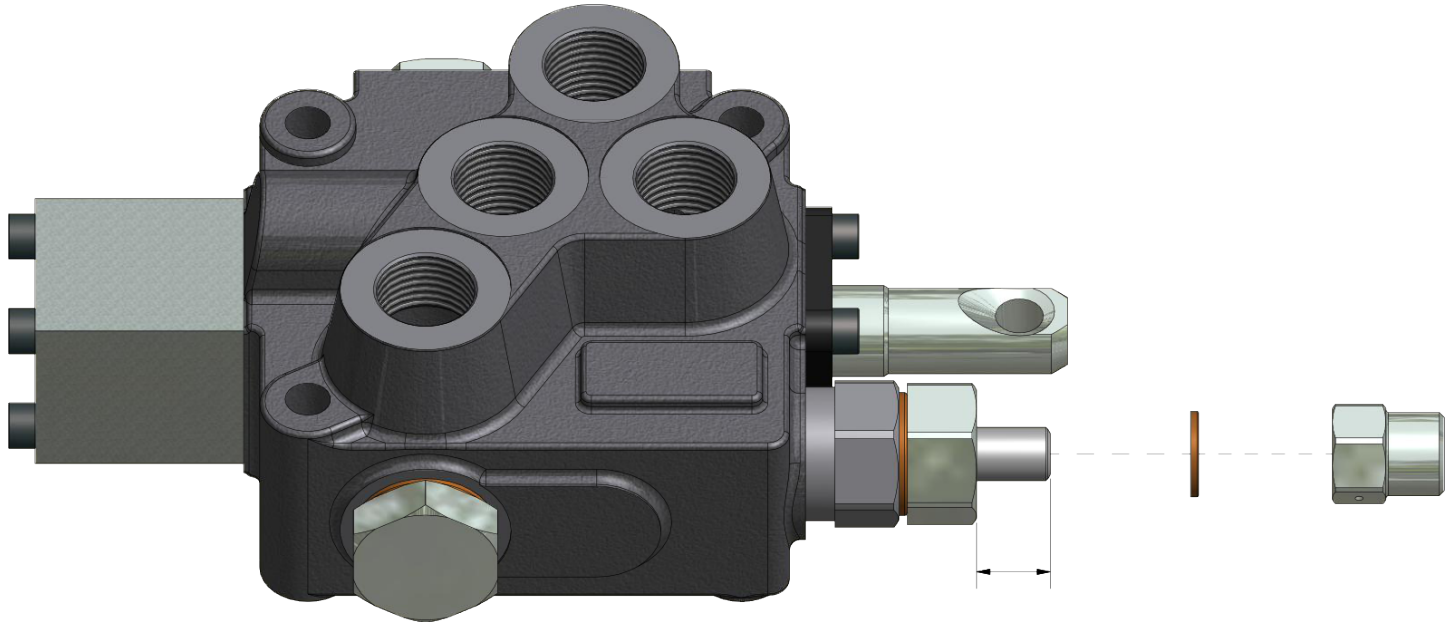

Figur 1 Illustration picture

#### Safety valve for servo circuit and elevation of splitting knives

- Item number 2955323
- Valid for serial No. From and including 09001 to and including 09025
- 5,5 mm threaded area from end till nut results approx 60 bar pressure

#### Valve for elevation of splitting knives

- Item number 2955329
- 9,8 mm threaded area from end till nut results approx 80 bar pressure
- Screws for "working gates".
  - M6 should have 8,0 mm total length included nut
  - M8 should have 14,5 mm total length included nut

#### Valve for splitting ram

- Item number 2955357
- 9,8 mm threaded area from end till nut results approx 80 bar pressure
- Screws for "working gates".
  - M6 should have 8,0 mm total length included nut
  - M8 should have 14,5 mm total length included nut

#### Valve for saw motor from and including serial No. 09046

- Item number 2955326
- 14,5 mm threaded area from end till nut results approx 180 bar pressure
- With bypass plug.

#### Valve for saw motor till and not including serial No. 09046

- Item number 2955325

- 14,5 mm threaded area from end till nut results approx 180 bar pressure
- Without bypass plug

### **Valve for log splitting**

- Item number 2955352
- 13,6 mm threaded area from end till nut results approx 210 bar pressure

### **Valve for feeding belt**

- Item number 2955354
- 14,9 mm threaded area from end till nut results approx 150 bar pressure

### **Valve for elevator**

- Item number 2955317
- 6,7 mm threaded area from end till nut results approx 30 bar pressure
- If a difference noise leve from the cooling fan is observed when the feeding belt start and stop, this valve must be adjusted. There should be no difference in noise level during this operation